

## STEEL flow SF 150 flat duct mount



Product number: 4061022

Configuration: galvanized steel

### Configuration options

4061022 | galvanized steel

✓ Exhaust air accessorie

✓ installation in the wall

✓ plug-in system

For laying the flat ducts on ceilings and walls.

— with damping

— recommended distance between two mounts 500 mm

— suitable for flat ducts SF-VRO flex and SF-VRO

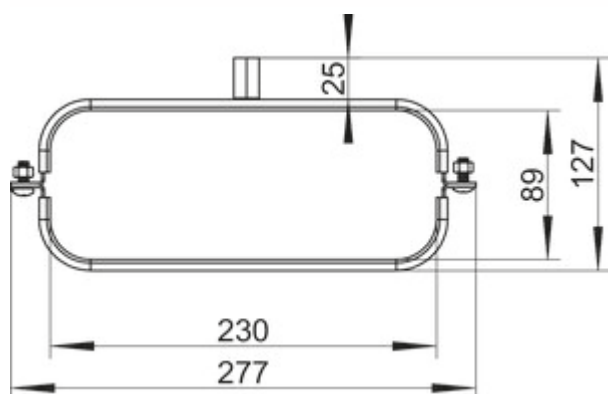

[more infos...](#)

### Technical data

|                 |  |                    |  |
|-----------------|--|--------------------|--|
| Article type    | Exhaust air accessorie                         | Suitable for       | suitable for flat ducts SF-VRO flex and SF-VRO |
| Brand           | STEEL flow                                     | Surface/coating    | galvanised                                     |
| Width           | 277 mm   | Shape              | angular  |
| Material        | galvanized steel                               | Outer diameter     | 150 mm   |
| Mounting/Fixing | installation in the wall<br>plug-in system     | Ventilation system | COMPAIR STEEL flow® 150                        |
| Note            | recommended distance between two mounts 500 mm |                    |  |

Technical drawing of the Naber SF 150 Flat Cable Hanger. The drawing includes three views: a top view showing a rectangular profile with rounded ends (R24), a side view showing the cable hanger's profile, and a detail view of the mounting bracket. Dimensions are provided in millimeters. The top view shows a width of 102mm and a height of 234mm. The side view shows a width of 20mm and a height of 243mm. The detail view shows a mounting bracket with an M10 thread and a 10mm offset.