



Stabilising strip

Product number: 1111125

Configuration: L 567 mm, white

Configuration options

1111125 | L 567 mm, white

1111126 | L 767 mm, white

1111127 | L 867 mm, white

1111128 | L 967 mm, white

1111129 | L 1167 mm, white

✓ Connecting materials

The stabilising strip for 16 mm sidewalls can be used universally as a spacer bar and in combination to support the worktop. This can be used upright as well as flat, depending on the requirement. Due to the design, a wooden panel can also be fitted in front mounting.

— to support long and narrow worktops

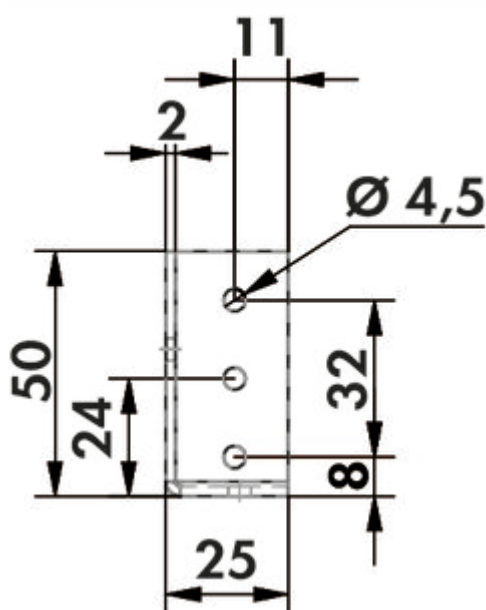

Technical data

Article type	Connecting materials	For sidewall thickness	16 mm
Width	567 mm		

[more infos...](#)